



**COLORADO:** Durango Activity

# CLIFF DWELLING DÉCOR



Can you imagine what it would be like to live in the side of a cliff like the Anasazi Indians did hundreds of years ago? What do you think your “bedroom” would look like?

How would you decorate your sandstone walls?

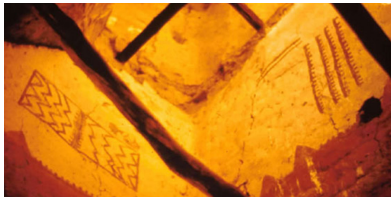

This painting was found inside a room at Cliff Palace in Mesa Verde National Park. Much like we paint and plaster our own houses today, Ancestral Puebloans used layers of colorful plaster to decorate their walls, inside and out.

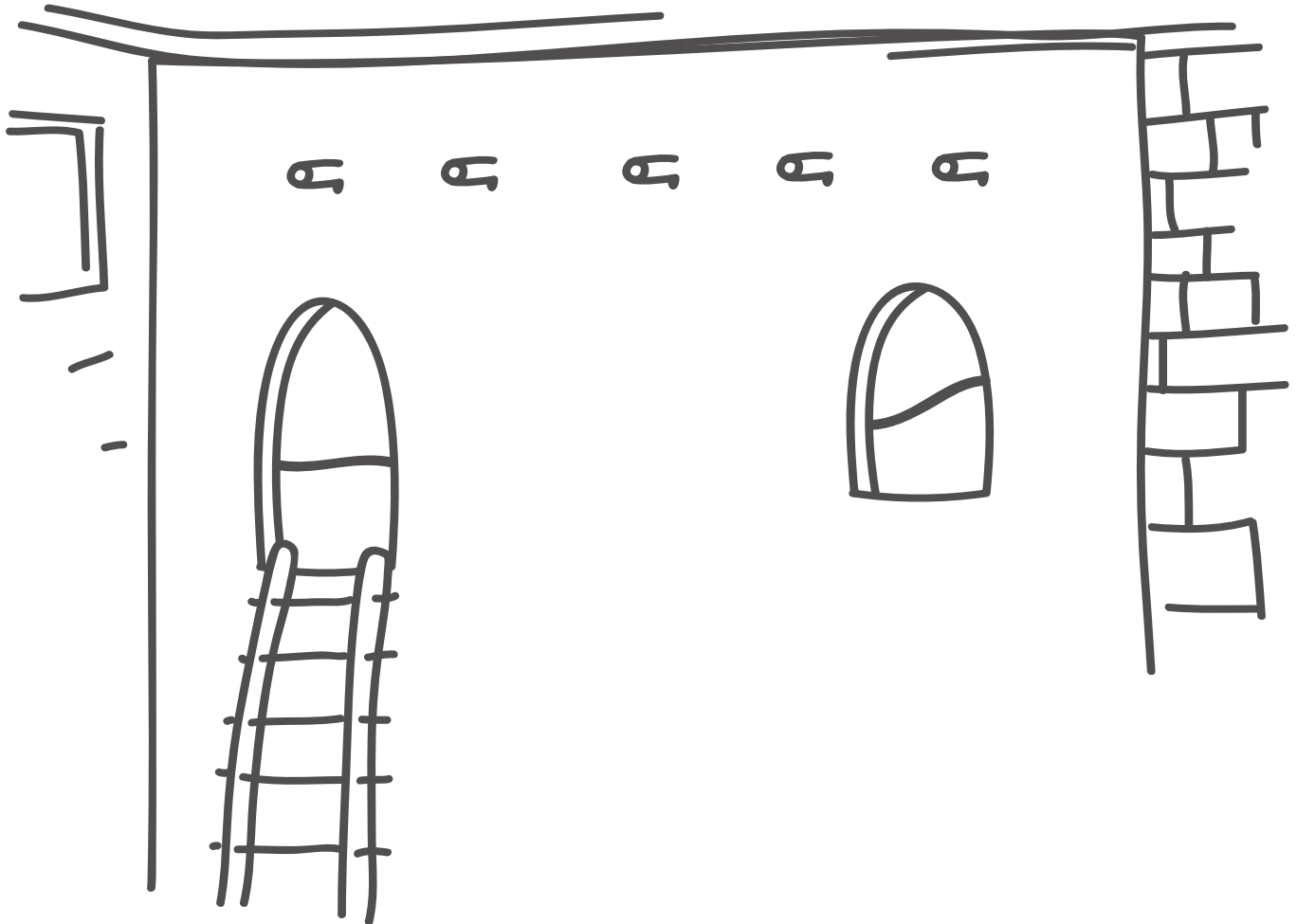

Paint your room, pueblo style, using some of these common ancestral designs or ones you create yourself. The Anasazi Indians would have used finger paints mixed from natural ingredients like berries or colorful flowers.

