



## The Nakamura Lock



1  
start  
like  
this



2



Fold in half lengthwise.  
Unfold to make a  
center crease.

CENTER CREASE



end up  
like  
this

3

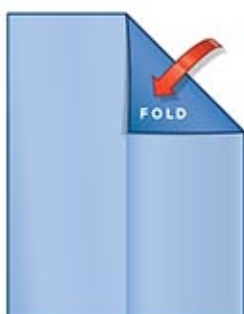

Fold the upper-right  
corner down so the  
top edge sits on the  
center crease.

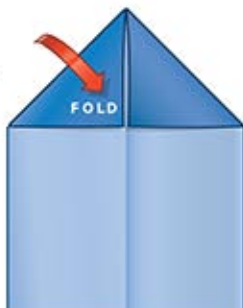

Do the same with the  
upper-left corner.

4

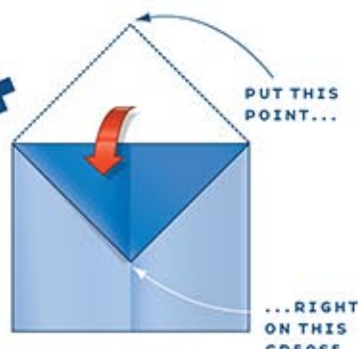

Fold the top point  
down, creasing right  
beneath the flaps you  
just made.

5



Put the upper-right  
corner on the center  
crease, about 1 inch  
(2.54 cm) above the  
point. Crease well.



Do the same with the  
upper-left corner.



more on next page





Flip the point up and fold so it's right on the center crease.



Fold in half. Make sure the edges of the left side line up perfectly with the edges on the right.

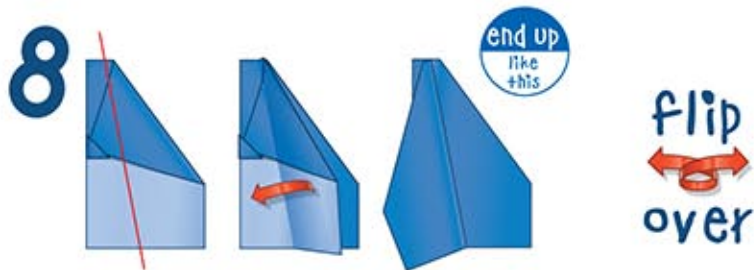

Fold just the top flap so that the crease falls on the red line shown.

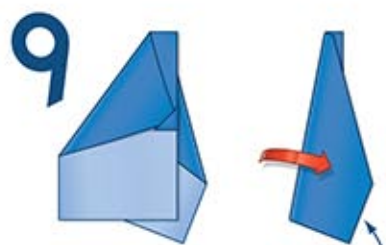

Fold the other wing so that it sits right on top of the first one.

LINE UP THE EDGES WITH THE WING YOU JUST MADE

ALMOST FINISHED



Unfold the wings part way, so that your plane looks like this from the back.

	TYPE: glider/dart
	FOLDING DIFFICULTY: 1
	FLY ZONE: <input checked="" type="checkbox"/> indoor
	<input type="checkbox"/> outdoor

Nakamura Lock

THROW CHART:

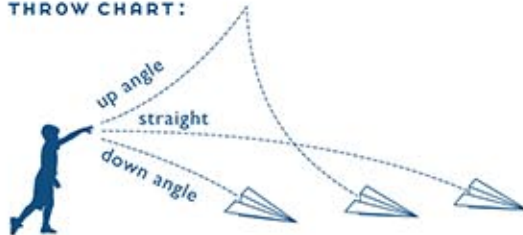

## FLYING THE NAKAMURA LOCK

This classic paper plane flies best with a light, straight-ahead toss.

